

CAB - Square pivot hinge for internal doors

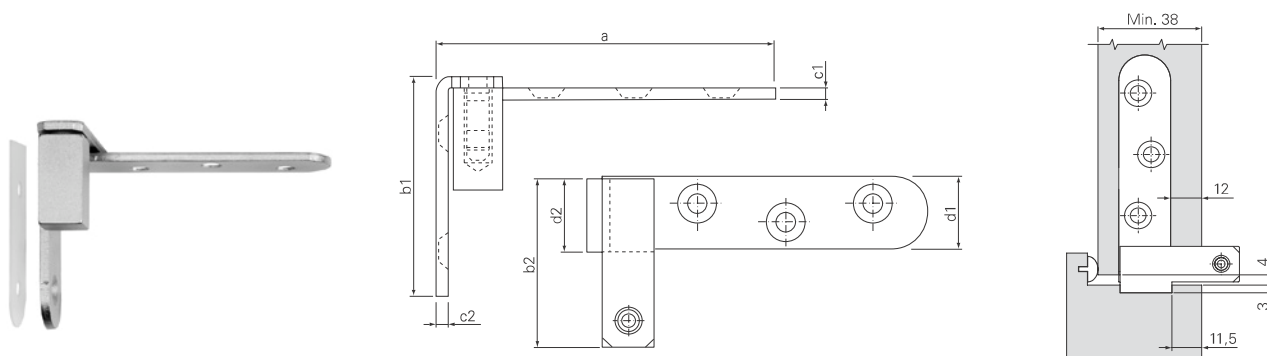

Technical information

a mm	b1 mm	b2 mm	c1 mm	c2 mm	d1 mm	d2 mm	
93.3	60.0	46.5	3.0	3.0	20.0	20.0	

Application

- For timber flush fit doors
- Load capacity per pair 55 kg

Product / Application	art. No	Material	Surface	Salt spray test hour	Pa-ckaging
CABS022SCO	1272701	Steel	Matt Chrome	20	10

Accessories

