



# Hahn Serie 60 AT

Universal hinge for versatile application



**MORE MODERN LOOK  
IMPROVED TECHNOLOGY**



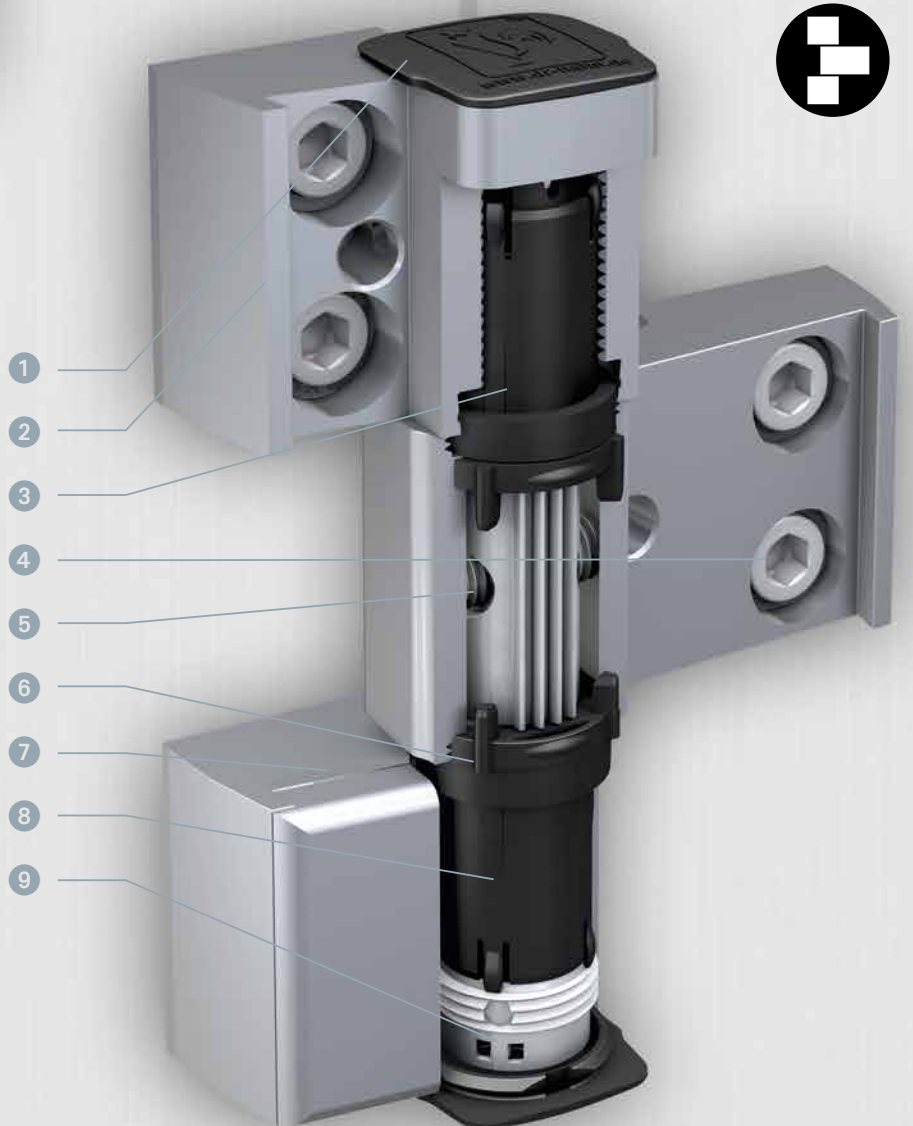
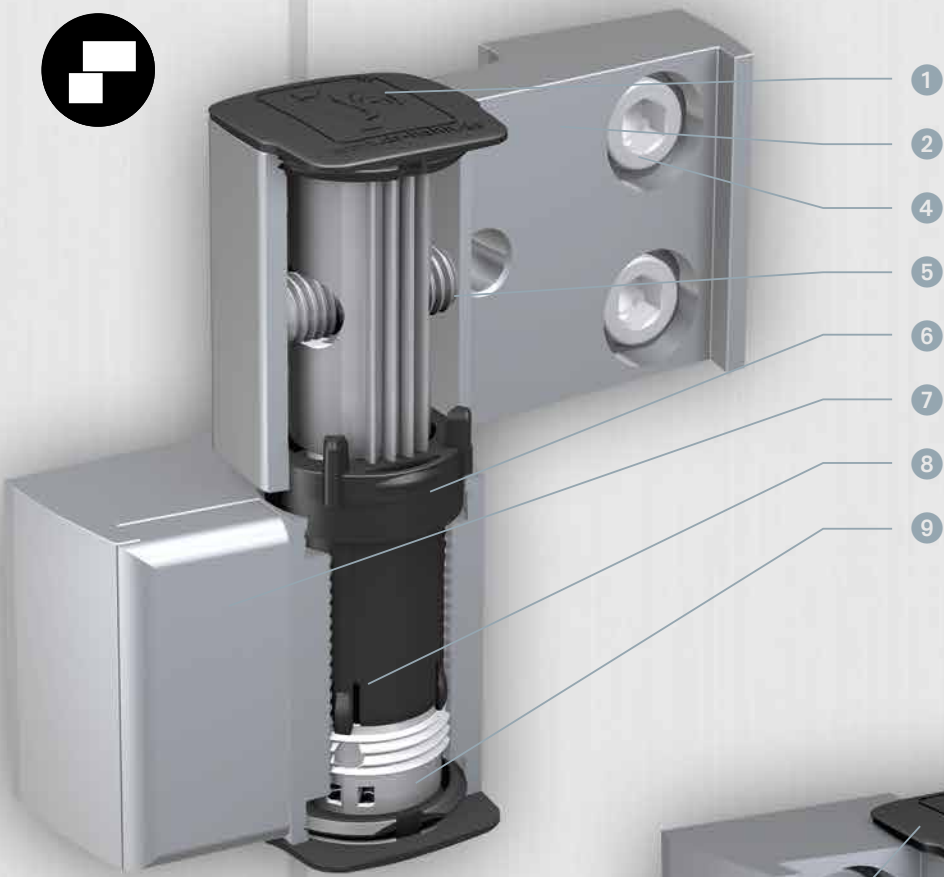

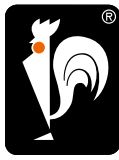

# Hahn Serie 60 AT

For all doors made from metal profile sections

- 1 **NEW!** Uniform caps  
– now with long-term hold
- 2 **Screw-on hinge of extruded aluminium** – withstands significant pressure and tensile forces
- 3 **Split stainless steel pins**  
– for easier disassembly
- 4 **NEW!** Choose freely between Hahn fastening elements  
– suits every profile situation

## **NEW!** Larger setting range

- 5 **Horizontal adjustment**  
 $\pm 2.5$  mm on installed doors  
– ensuring an optimum fit
- 6 **Both parts of the hinges are equipped with a synthetic sleeve offering**  
– improved antifriction property
- 7 **NEW!** Cover strip secured  
– for improved protection against break-ins

## **NEW!** Adjustable with door leaf installed

- 8 **Adjust sealing pressure**  
 $\pm 0.5$  mm (necessary to remove the door leaf for some variations)
- 9 **Height adjustment using integrated lifting and lowering spindle** – continually variable + 3 mm/–2 mm and easy adjustment

## Other advantages

- Adjustable in six directions while door leaf is mounted
- Capable of supporting up to 220 kg (3-piece) or 140 kg (2-piece) depending on the design of the profile sections
- Available for all common aluminium and steel profile sections
- The standard version comes with high corrosion resistance
- The hinge system offers a variety of possible combinations and mounting options for inward and outward opening doors with alternating profile and corner post construction
- Can be used on left or right
- Special designs for folding doors and intrusion-resistant doors
- Hinges available in anodised and RAL colours
- Bearing point maintenance-free – no lubrication necessary

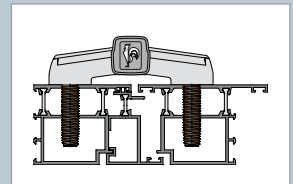
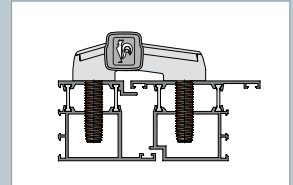
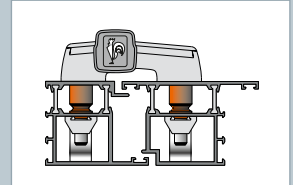
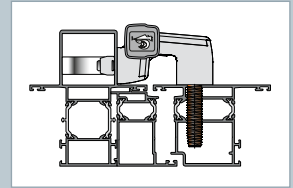



Hahn Serie 60 AT ...



... more convenience  
for door makers

A hinge for (almost) every application:  
Hahn Serie 60 AT hinges are universally  
usable for almost all system profiles.  
They are durable and always remain stable  
even when subject to intensive use.  
Both parts of the hinge are equipped  
with a low-maintenance bearing bushing.  
That improves the antifriction properties  
for several hundred thousand cycles.  
Moreover, it can be adjusted in six  
directions – by one person and without  
having to loosen the fastening screws,  
and now even when the door leaf is  
already installed.

### Installation instructions

Fastening method anchor screw

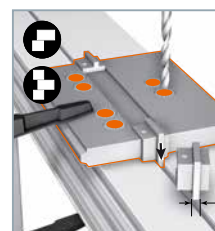

Drill 11 mm diameter  
holes.



## Convenient and reliable

The cover strips are equipped with a tension bolt, which is fixed from behind and which prevents access to the fastening screws. To contribute to protection against break-ins, Hahn offers security sets as an accessory for doors that open outward. The hinge system offers a variety of possible combinations and mounting options for inward and outward opening doors with reversible profile and corner post construction.

## Adjustment instructions

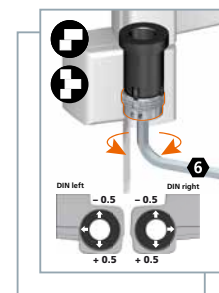

**Adjusting the sealing pressure**  
 Increase sealing pressure: + 0.5 mm, mark points towards the door. Decrease sealing pressure: - 0.5 mm, mark points away from the door.

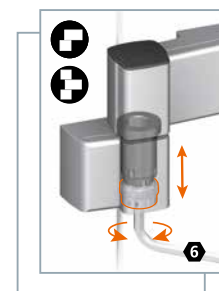

**Adjusting the height**  
 + 3/- 2 mm

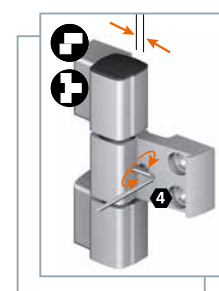

**Horizontal adjustment**  
 ± 2.5 mm

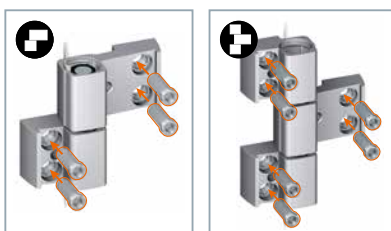

Tighten screws of the hinge body (20–25 Nm).



Slide tension bolt into cover strip. Snap-on cover strip. Snap caps in place.

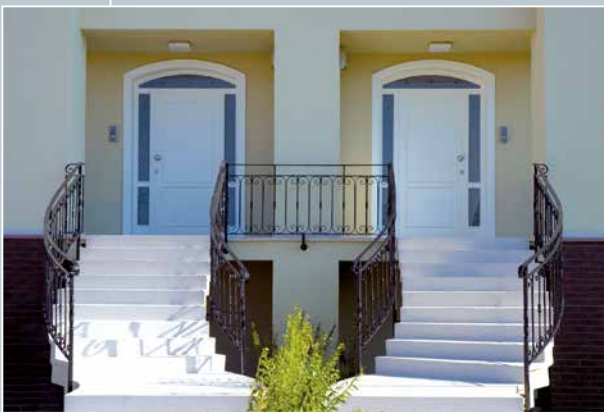
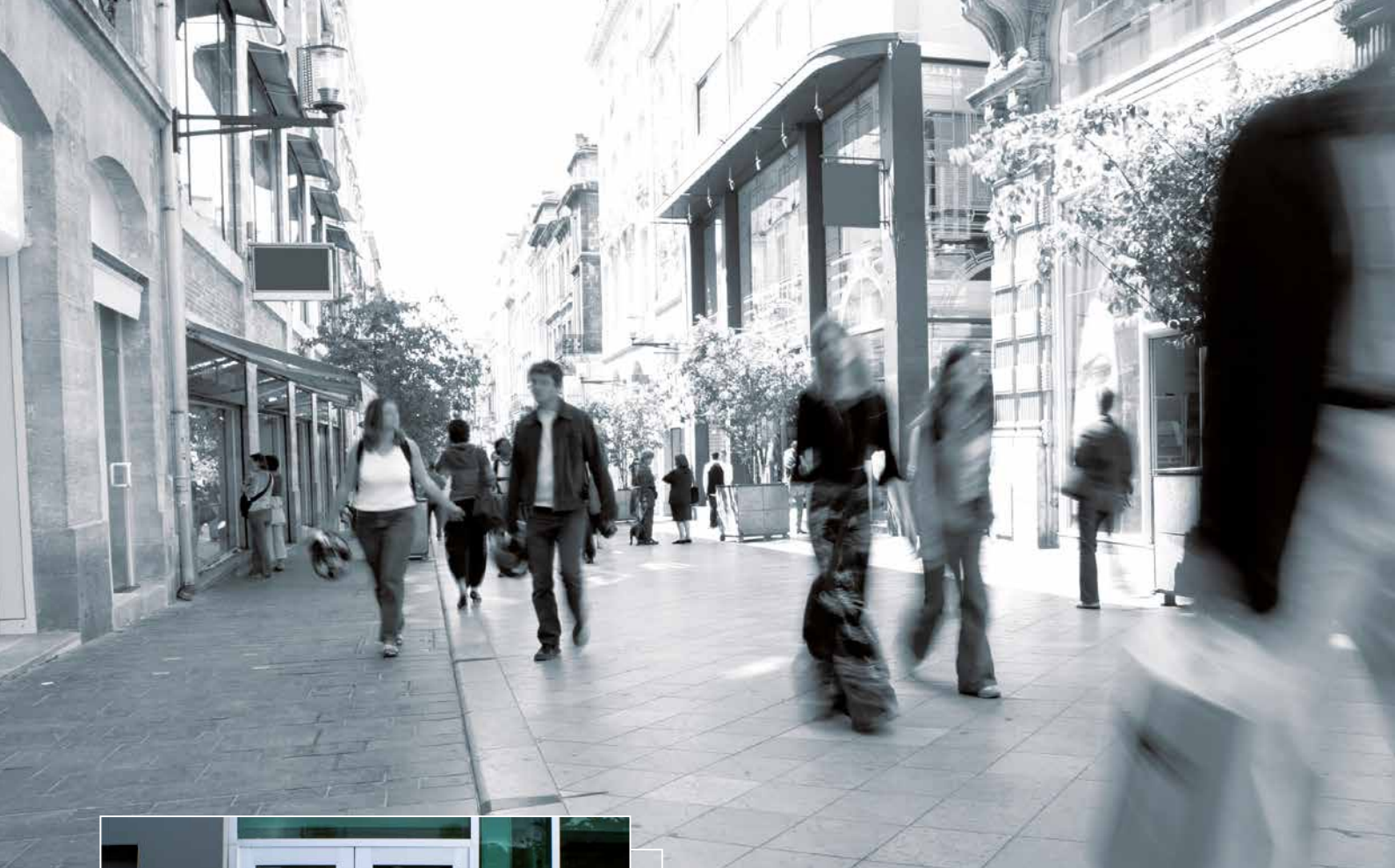

## For all doors made from metal profile sections











Be it main doors, side doors or functional doors, interior, exterior or entry doors, the Hahn Serie 60 AT is a door hinge that performs as expected for the long term. Before a Hahn hinge can be rolled out, the ready-for-production hinge is subjected to testing with over 200,000 opening cycles. In doing so, the hinge must also prove itself under unfavourable conditions. It is only after these tests have been completed successfully that the hinge can be released. This guarantees that a Hahn hinge is reliable over the long term, a benefit that is much appreciated by architects, system suppliers, door makers and building owners.

**MADE IN GERMANY**

## CE certification in preparation

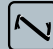
A CE certification application has also been filed for the new versions of the Serie 60 AT. The objective is to achieve at least the same hinge classes that the previous series did. With a hinge class 14, the 2-piece versions obtained the currently highest rating for single-axis door hinges. The 3-piece version received the hinge class 12 due to special testing criteria, whereby the testing laboratory certified a high load capacity. Suitability for use of the standard version in fire-proof doors is a priority.

The current series can still be ordered until the CE tests are completed and the certificates issued.

|  |  |  |  |  |  |  |  |  |
|--|---|---|---|---|--|---|---|---|
|  | Service classes   | Durability  | Weight of test door   | Fire resistance   | Security   | Corrosion resistance  | Intrusion protection  | Hinge class   |
| <b>SERIE 60 AT</b>  | 4   | 7   | 7   | 0   | 1  | 4   | 0   | 14  |
| <b>SERIE 60 AT</b>  | 4   | 7   | 5   | 1   | 1  | 4   | 1   | 12  |

**SERIE 60 AT**  EC Certificate No. **1309-CPD-0003**

The classification **4 7 7 0 1 4 0 14** means: a door hinge for (4) very heavy usage, which has undergone endurance testing of (7) 200,000 cycles, for a door with dimensions of up to (7\*) 160 kg, not suited for (0) fire and smoke protection, possesses a (4) corrosion resistance of 240 h and can be used on (0) doors that are not rated as intrusion-resistant.

**SERIE 60 AT**  EC Certificate No. **1309-CPD-0001**

The classification **4 7 5 1 1 4 1 12** means: a door hinge for (4) very heavy usage, which has undergone endurance testing of (7) 200,000 cycles, for a door with dimensions of up to (5\*\*) 100 kg, suited for (1) fire and smoke protection, possesses a (4) corrosion resistance of 240 h and can be used on (1) intrusion-resistant doors.

\* In addition to that, testing was conducted based on 20 cycles with 320 kg and 5 cycles with 480 kg and successfully completed in accordance with EN 1935.

\*\* In addition to that, testing was conducted based on 20 cycles with 200 kg and 5 cycles with 300 kg and successfully completed in accordance with EN 1935. The product verifiably withstands a heavy load of at least 6.0 kN.



## Hardly possible to be more universal

The requirements placed on hinge mounting are just as diverse as the system landscapes that hinges have to serve. For this reason, Dr. Hahn developed the Hahn screw anchor revolutionising hinge mounting in 2003. The Hahn anchor screw followed in 2007. Both fastening methods have now become permanent fixtures in the workshops of door installation firms world-wide. For the first time ever, a Hahn hinge can now utilise the entire range, including adjustable spacing collars, with the new Hahn Serie 60 AT. Of course, it depends on the door situation that the installer has to deal with. For hinges with a pivoting point of 20 mm, installers can decide on their own which mounting method they would like to order additionally for the hinge. Delivery of hinges with pivoting points other than 20 mm or 36 mm always take place completely in a box incl. fastening elements. As a result, the Hahn Serie 60 AT is able to satisfy a wide variety of situations and offers door installers maximum flexibility.

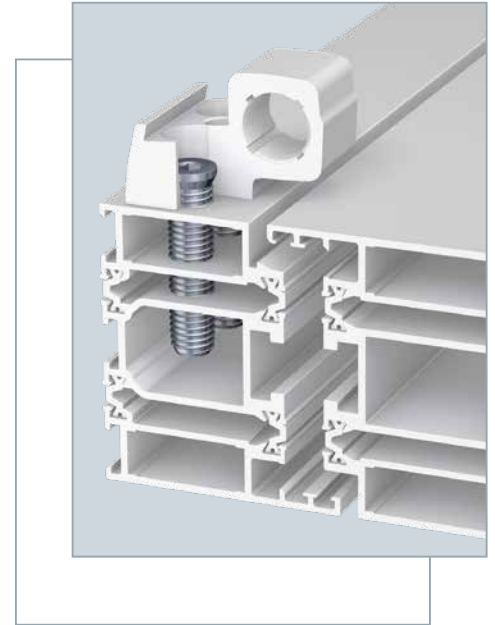

**NEW!** The Hahn Serie 60 AT is now also available for individual borehole gauges in a practical industry package of 24 hinges (2-piece) or 18 hinges (3-piece). Original Hahn fastening elements can also be ordered as needed (see page 16).





# Hahn Serie 60 AT

Universal hinge for metal doors

## SYSTEM

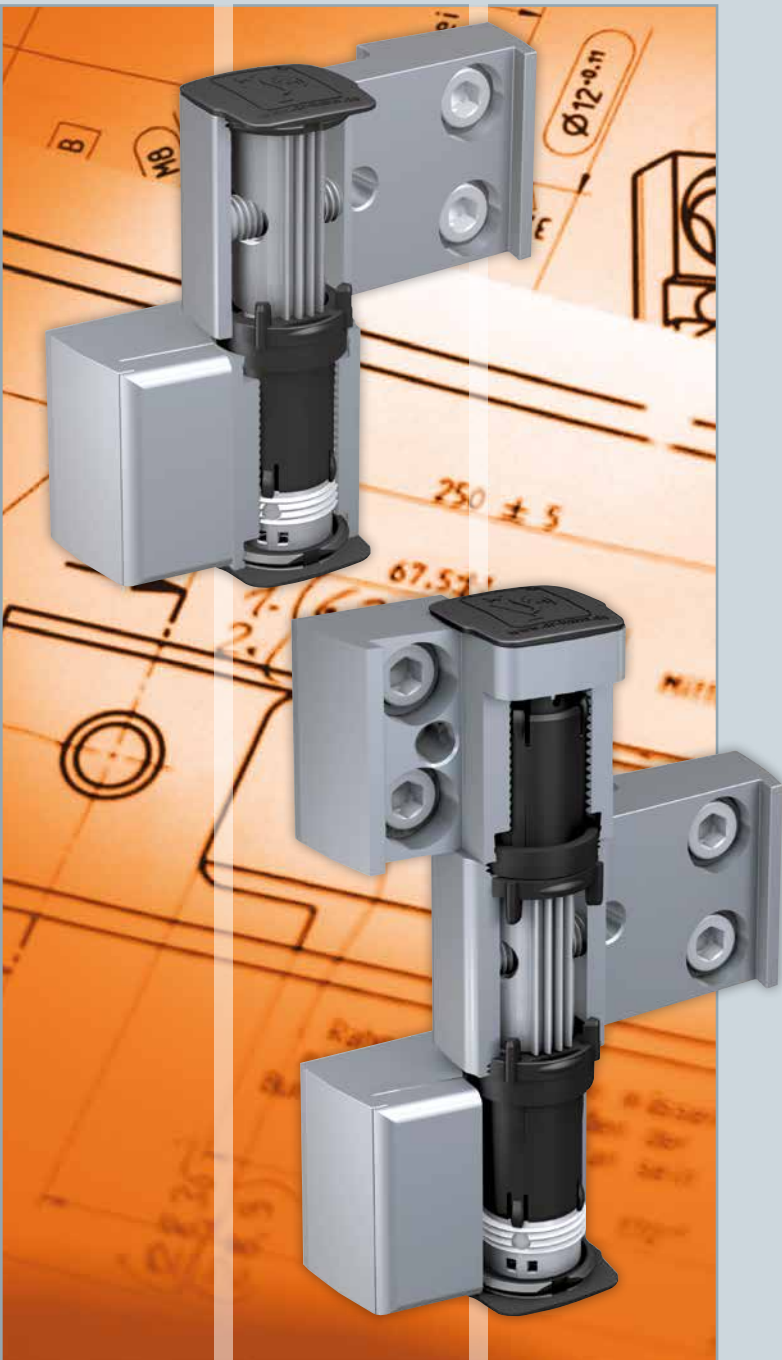

### System/Application

- **Material**  
Made of extruded aluminium
- **Fastening methods**  
Fastening using anchor screw, screw anchor or section reinforcement plates 15 and 21 mm
- **Versions**  
Two pivoting points: 20 mm and 36 mm
- **Load capacity**  
Depending on profile section design, max. 140 kg (2-piece), max. 220 kg (3-piece)
- **Adjustability**  
Door leaf adjustable in six directions:
  - Horizontal adjustment, variable up to  $\pm 2.5$  mm
  - Vertical adjustment using integrated lifting and lowering spindle, raising + 3 mm, lowering - 2 mm
  - Sealing pressure  $\pm 0.5$  mm
- **Colours**  
Hinges available in anodised and RAL colours
- **Doors open up to > 180°**
- **Bearing point maintenance-free**



## Drilling jigs

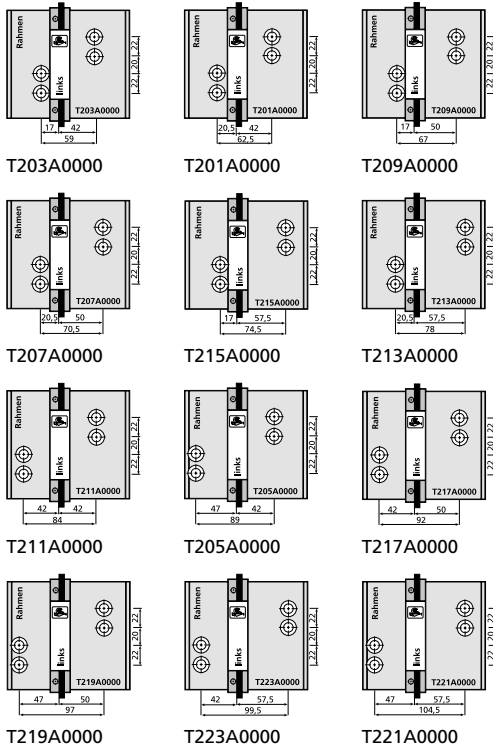

## Drilling jigs

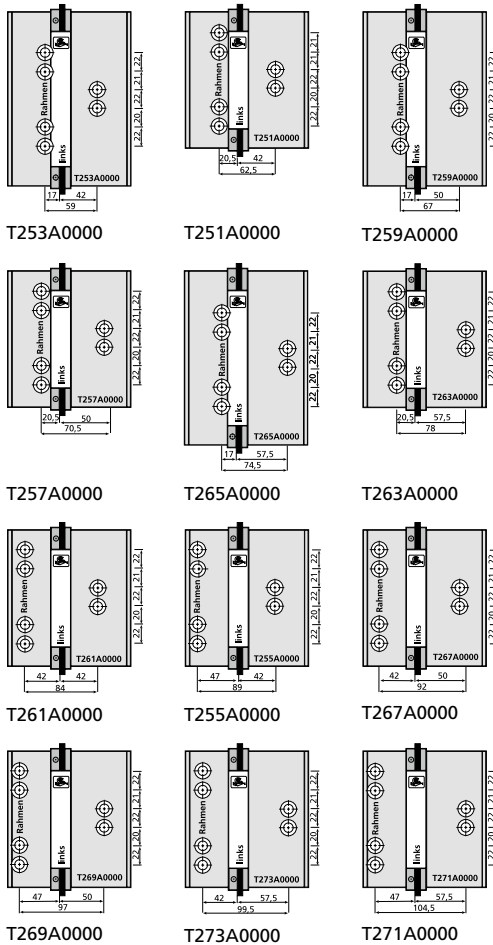

## General suggestions for hinge placement

The following design fundamentals are authoritative for hinge placement: size and weight of door, wall thickness of section, frame design, how the door opens, type of loading, hinge mounting. This information is essential for a precise design calculation.

|              | Object                           | Max. door size [mm] | Max. door weight [kg] | Upper door closer | Swing door drive mechanism | Closing sequence controller |
|--------------|----------------------------------|---------------------|-----------------------|-------------------|----------------------------|-----------------------------|
| Normal usage | Detached house                   | 1,250 x 2,000       | 120                   |                   |                            |                             |
|              | Detached house                   | 1,250 x 2,000       | 140                   |                   |                            |                             |
|              | Building with multiple dwellings | 1,250 x 2,000       | 120                   |                   |                            |                             |
|              | Building with multiple dwellings | 1,250 x 2,000       | 140                   |                   |                            |                             |
|              | Building with multiple dwellings | 1,250 x 2,000       | 120                   | ■                 |                            |                             |
|              | Building with multiple dwellings | 1,250 x 2,000       | 140                   | ■                 |                            |                             |
| Heavy usage  | Hospital, school, ...            | 1,250 x 2,000       | 120                   | ■                 |                            |                             |
|              | Hospital, school, ...            | 1,250 x 2,000       | 140                   |                   |                            |                             |
|              | Hospital, school, ...            | 1,250 x 2,000       | 120                   |                   | ■                          |                             |
|              | Hospital, school, ...            | 1,250 x 2,000       | 140                   |                   | ■                          |                             |
|              | Hospital, school, ...            | 1,250 x 2,000       | 120                   |                   |                            | ■                           |
|              | Hospital, school, ...            | 1,250 x 2,000       | 140                   |                   |                            | ■                           |

These general hinge placement suggestions take into account frame sections of normal width (approx. 45 mm) with wall thicknesses of approx. 2 mm. Since the individual door frame systems vary significantly in terms of projected widths and wall thicknesses and the mounting of hinges to the frame play a major role, we recommend that you make use of our free design calculation service, should you have any doubts. To determine the necessary placement of hinges, various information is required. Please request our questionnaire on hinge placement. **Please note:** All statements and calculations relate exclusively to Original Hahn hinges in conjunction with original Hahn fastening elements and take into account their specific characteristics.

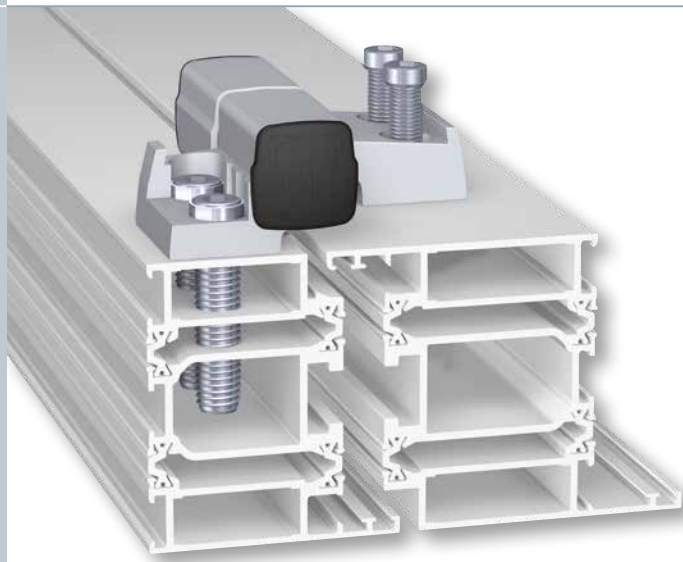

**NEW!** Now with Hahn anchor screw for especially fast processing

| Recommended hinge placement | Arrangement  |
|-----------------------------|--|
| 2 units 2-piece             | Distance from door edge approx. 150 mm                           |
| 3 units 2-piece             | Third hinge approx. 150 mm below the top hinge                   |
| 2 units 3-piece             | Distance from door edge approx. 150 mm                           |
| 3 units 3-piece             | Third hinge approx. 150 mm below the top hinge                   |
| 3 units 3-piece             | Third hinge approx. 150 mm below the top hinge                   |
| 4 units 3-piece             | Third hinge approx. 150 mm below the top hinge, fourth in middle |
| 3 units 3-piece             | Third hinge approx. 150 mm below the top hinge                   |
| 4 units 3-piece             | Third hinge approx. 150 mm below the top hinge, fourth in middle |
| 3 units 3-piece             | Third hinge approx. 150 mm below the top hinge                   |
| 4 units 3-piece             | Third hinge approx. 150 mm below the top hinge, fourth in middle |
| 3 units 3-piece             | Third hinge approx. 150 mm below the top hinge                   |
| 4 units 3-piece             | Third hinge approx. 150 mm below the top hinge, fourth in middle |

### Versions for installation with all Hahn fastening elements

|                                      |                                      |                                      |
|--------------------------------------|--------------------------------------|--------------------------------------|
| <p> M701 □ E000<br/> M751 □ E000</p> | <p> M703 □ E000<br/> M753 □ E000</p> | <p> M709 □ E000<br/> M759 □ E000</p> |
| <p> M707 □ E000<br/> M757 □ E000</p> | <p> M715 □ E000<br/> M765 □ E000</p> | <p> M713 □ E000<br/> M763 □ E000</p> |
| <p> M704 □ E000<br/> M754 □ E000</p> | <p> M702 □ E000<br/> M752 □ E000</p> | <p> M710 □ E000<br/> M760 □ E000</p> |
| <p> M716 □ E000<br/> M766 □ E000</p> | <p> M718 □ E000<br/> M768 □ E000</p> | <p> M720 □ E000<br/> M770 □ E000</p> |



Bearing points made of maintenance-free plastic containing Teflon – do not lubricate!

Many other applications available on request



# Separate order of hinge and fastening elements

Pivoting point 20 mm

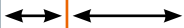
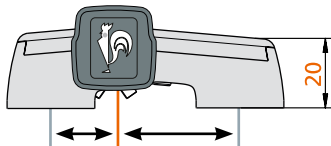

|      |         | Bore hole gauge | Profile combination for inward opening doors (example) |      | Profile combination for outward opening doors (example) |      | Profile combination for inward opening doors with alternating section (example) |      |
|------|---------|-----------------|--|------|---|------|---|------|
|      |         |                 |  |      |   |      |   |      |
|      |         |                 |  |      |   |      |   |      |
| 17   | 42 mm   | 59 mm           | M703   | M753 | M703  | M753 |   |      |
| 17   | 50 mm   | 67 mm           | M709   | M759 | M709  | M759 |   |      |
| 20.5 | 42 mm   | 62.5 mm         | M701   | M751 | M701  | M751 |   |      |
| 20.5 | 50 mm   | 70.5 mm         | M707   | M757 | M707  | M757 |   |      |
| 17   | 57.5 mm | 74.5 mm         |  |      |   |      | M715  | M765 |
| 20.5 | 57.5 mm | 78 mm           |  |      |   |      | M713  | M763 |
| 42   | 42 mm   | 84 mm           |  |      |   |      |   |      |
| 42   | 50 mm   | 92 mm           |  |      |   |      |   |      |
| 42   | 57.5 mm | 99.5 mm         |  |      |   |      |   |      |
| 47   | 42 mm   | 89 mm           |  |      |   |      |   |      |
| 47   | 50 mm   | 97 mm           |  |      |   |      |   |      |
| 47   | 57.5 mm | 104.5 mm        |  |      |   |      |   |      |

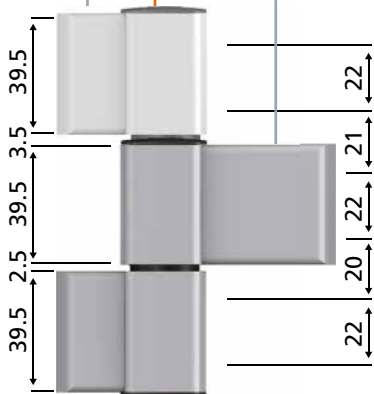

Mounting plates

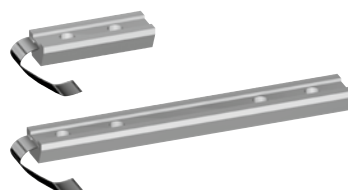

Anchor screws



For item numbers of fastening elements, see page 16



Profile combination for outward opening doors with alternating section (example)

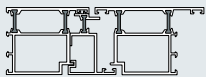

**Colour key**  
Other colours available. Please indicate separately.

0 = unfinished, for anodisation  
1 = EV1 anodised  
2 = unfinished, for coating  
R = Electro-coated in matt brown  
4 = RAL 9010 coated  
5 = RAL 8077 coated  
6 = RAL 9016 coated  
9 = other colour as per specification

**Packing unit**

Single unit package PU = 1  
Industry package PU = 24  
Industry package PU = 18

**Your stock number**

Basic designation  
Colour number  
Packing unit

**Drilling jigs**

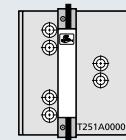
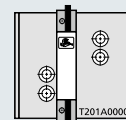

**Item number**

T □ □ □ A0000



M711

M761

0 1 2 R 4 5 6 9 E000

M7 □ □ □ □ □ □ □ □

2 0 3 2 5 3

\*)

M767

0 1 2 R 4 5 6 9 E000

M7 □ □ □ □ □ □ □ □

209 259

\*)

M773

0 1 2 R 4 5 6 9 E000

M7 □ □ □ □ □ □ □ □

201 251

M705

M755

0 1 2 R 4 5 6 9 E000

M7 □ □ □ □ □ □ □ □

207 257

\*)

M769

0 1 2 R 4 5 6 9 E000

M7 □ □ □ □ □ □ □ □

215 265

\*)

M771

0 1 2 R 4 5 6 9 E000

M7 □ □ □ □ □ □ □ □

213 263

\*) We recommend using a 3-piece variation

**Sample order**

- Hahn Universal Hinge Serie 60 AT  
3-piece  
Bore hole gauge 89 mm  
Pivoting point 20 mm

Assigned number as per product overview: M755\_

M755 □ □ □ □ □ □ □ □

- Electro-coated in matt brown

M755R □ □ □ □ □ □ □ □

- Single unit package

M755RE000

Alternative designs and combinations based on installation drawing or their description: Designs and combinations receive individual stock numbers.

**Screw anchor**



For item numbers of fastening elements, see page 16



# Separate order of hinge and fastening elements

Pivoting point 36 mm

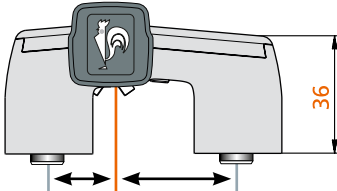

17 42 mm

17 50 mm

20.5 42 mm

20.5 50 mm

17 57.5 mm

20.5 57.5 mm

42 42 mm

42 50 mm

42 57.5 mm

47 42 mm

47 50 mm

47 57.5 mm

20.5 42 mm

20.5 57.5 mm

Bore hole gauge

Profile combination for inward opening doors (example)

Profile combination for outward opening doors (example)

Profile combination for inward opening doors with alternating section (example)

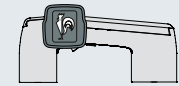
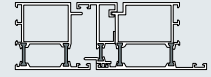
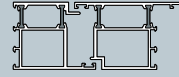
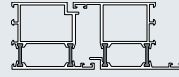

M704 M754

M704 M754

M710 M760

M710 M760

M702 M752

M702 M752

M708 M758

M708 M758

M716 M766

M714 M764

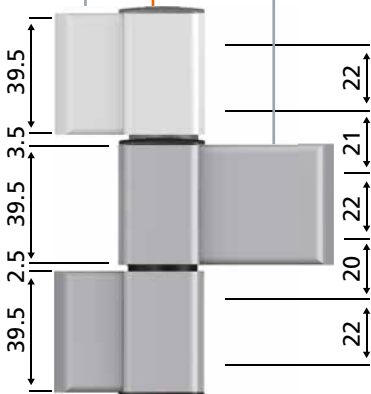

Mounting plates

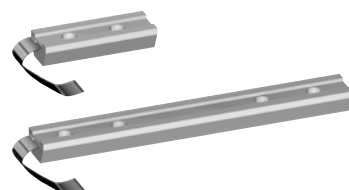

Anchor screws



For item numbers of fastening elements, see page 16

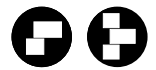

| Profile combination for outward opening doors with alternating section (example) |        | Profile combination for corner post construction (example) |  | Colour key  | Packing unit               |                          |                          | Your stock number  | Drilling jigs  |   |
|--|--------|--|--|---|----------------------------|--------------------------|--------------------------|--|--|---|
|  |        |  |  | Other colours available. Please indicate separately<br>0 = unfinished, for anodisation<br>1 = EV1 anodised<br>2 = unfinished, for coating<br>R = Electro-coated in matt brown<br>4 = RAL 9010 coated<br>5 = RAL 8077 coated<br>6 = RAL 9016 coated<br>9 = other colour as per specification | Single unit package PU = 1 | Industry package PU = 24 | Industry package PU = 18 | Basic designation<br>Colour number<br>Packing unit   | <br>   |   |
|  |        |  |  |   |                            |                          |                          |  |  | Item number<br>T <input type="text"/> <input type="text"/> <input type="text"/> A0000 |
|  |        |  |  | 0 1 2 R 4 5 6 9   |                            |                          |                          | M7 <input type="text"/> <input type="text"/> <input type="text"/> <input type="text"/> <input type="text"/> <input type="text"/> <input type="text"/> <input type="text"/> | 2 0 3  | 2 5 3   |
|  |        |  |  | 0 1 2 R 4 5 6 9   |                            |                          |                          | M7 <input type="text"/> <input type="text"/> <input type="text"/> <input type="text"/> <input type="text"/> <input type="text"/> <input type="text"/> <input type="text"/> | 209  | 259   |
|  |        |  |  | 0 1 2 R 4 5 6 9   |                            |                          |                          | M7 <input type="text"/> <input type="text"/> <input type="text"/> <input type="text"/> <input type="text"/> <input type="text"/> <input type="text"/> <input type="text"/> | 201  | 251   |
|  |        |  |  | 0 1 2 R 4 5 6 9   |                            |                          |                          | M7 <input type="text"/> <input type="text"/> <input type="text"/> <input type="text"/> <input type="text"/> <input type="text"/> <input type="text"/> <input type="text"/> | 207  | 257   |
|  |        |  |  | 0 1 2 R 4 5 6 9   |                            |                          |                          | M7 <input type="text"/> <input type="text"/> <input type="text"/> <input type="text"/> <input type="text"/> <input type="text"/> <input type="text"/> <input type="text"/> | 215  | 265   |
|  |        |  |  | 0 1 2 R 4 5 6 9   |                            |                          |                          | M7 <input type="text"/> <input type="text"/> <input type="text"/> <input type="text"/> <input type="text"/> <input type="text"/> <input type="text"/> <input type="text"/> | 213  | 263   |
| M712   | M762   |  |  | 0 1 2 R 4 5 6 9   |                            |                          |                          | M7 <input type="text"/> <input type="text"/> <input type="text"/> <input type="text"/> <input type="text"/> <input type="text"/> <input type="text"/> <input type="text"/> | 211  | 261   |
| M718   | M768   |  |  | 0 1 2 R 4 5 6 9   |                            |                          |                          | M7 <input type="text"/> <input type="text"/> <input type="text"/> <input type="text"/> <input type="text"/> <input type="text"/> <input type="text"/> <input type="text"/> | 217  | 267   |
| M724   | M774   |  |  | 0 1 2 R 4 5 6 9   |                            |                          |                          | M7 <input type="text"/> <input type="text"/> <input type="text"/> <input type="text"/> <input type="text"/> <input type="text"/> <input type="text"/> <input type="text"/> | 223  | 273   |
| M706   | M756   |  |  | 0 1 2 R 4 5 6 9   |                            |                          |                          | M7 <input type="text"/> <input type="text"/> <input type="text"/> <input type="text"/> <input type="text"/> <input type="text"/> <input type="text"/> <input type="text"/> | 205  | 255   |
| M720   | M770   |  |  | 0 1 2 R 4 5 6 9   |                            |                          |                          | M7 <input type="text"/> <input type="text"/> <input type="text"/> <input type="text"/> <input type="text"/> <input type="text"/> <input type="text"/> <input type="text"/> | 219  | 269   |
| **)  | M772   |  |  | 0 1 2 R 4 5 6 9   |                            |                          |                          | M7 <input type="text"/> <input type="text"/> <input type="text"/> <input type="text"/> <input type="text"/> <input type="text"/> <input type="text"/> <input type="text"/> | 221  | 271   |
|  | M749*) | M799*)   |  | 0 1 2 R 4 5 6 9   |                            |                          |                          | M7 <input type="text"/> <input type="text"/> <input type="text"/> <input type="text"/> <input type="text"/> <input type="text"/> <input type="text"/> <input type="text"/> | Please contact us for the article number of corner hinge combinations. |   |
|  | M748*) | M798*)   |  | 0 1 2 R 4 5 6 9   |                            |                          |                          | M7 <input type="text"/> <input type="text"/> <input type="text"/> <input type="text"/> <input type="text"/> <input type="text"/> <input type="text"/> <input type="text"/> |  |   |

\*) When ordering corner post constructions, please indicate the profile section system and profile combination.  
 \*\*) Item number on request

### Screw anchor



For item numbers of fastening elements, see page 16

### Sample order

- Hahn Universal Hinge Serie 60 AT  
 2-piece  
 Bore hole gauge 62.5 mm  
 Pivoting point 36 mm  
 Assigned number as per product overview: M702...  
 M7 02
- RAL 9010 coated  
 M7 02 4
- Industry package PU = 24  
 M7 02 4  000

Alternative designs and combinations based on installation drawing or their description: Designs and combinations receive individual stock numbers.



## Anchor screw

| Variation |         |                    | Item number | PU for* | Variation |           |                  | Item number | PU for* |
|-----------|---------|--------------------|-------------|---------|-----------|-----------|------------------|-------------|---------|
|           | 37.5 mm | Steel              | VP02A0012   | 1       |           | 37.5 mm   | Stainless steel  | VP02A0013   | 1       |
|           |         |                    | VP03A0012   | 1       |           |           |                  | VP03A0013   | 1       |
|           | 19.5 mm | Effective length   | VP02B0012   | 24      |           | VP02B0013 | 24               |             |         |
|           |         |                    | VP03C0012   | 18      |           | VP03C0013 | 18               |             |         |
|           | 48 mm   | Steel              | VP02A0014   | 1       |           | 48 mm     | Stainless steel  | VP02A0015   | 1       |
|           |         |                    | VP03A0014   | 1       |           |           |                  | VP03A0015   | 1       |
|           | 30 mm   | Effective length   | VP02B0014   | 24      |           | VP02B0015 | 24               |             |         |
|           |         |                    | VP03C0014   | 18      |           | VP03C0015 | 18               |             |         |
|           | 58 mm   | Steel              | VP02A0016   | 1       |           | 58 mm     | Stainless steel  | VP02A0017   | 1       |
|           |         |                    | VP03A0016   | 1       |           |           |                  | VP03A0017   | 1       |
|           | 40 mm   | Effective length   | VP02B0016   | 24      |           | VP02B0017 | 24               |             |         |
|           |         |                    | VP03C0016   | 18      |           | VP03C0017 | 18               |             |         |
|           | 74 mm   | Steel              | VP02A0019   | 1       |           | 74 mm     | Stainless steel  | VP02A0020   | 1       |
|           |         |                    | VP03A0019   | 1       |           |           |                  | VP03A0020   | 1       |
|           | 56 mm   | Effective length   | VP02B0019   | 24      |           | VP02B0020 | 24               |             |         |
|           |         |                    | VP03C0019   | 18      |           | VP03C0020 | 18               |             |         |
|           | 58 mm   | For steel profiles | VP02A0018   | 1       |           | 58 mm     | Effective length | VP02B0018   | 24      |
|           |         |                    | VP03A0018   | 1       |           |           |                  | VP03C0018   | 18      |
|           | 40 mm   | Effective length   | VP02B0018   | 24      |           |           |                  |             |         |
|           |         |                    | VP03C0018   | 18      |           |           |                  |             |         |

## Screw anchor

|  |       |                    |           |    |  |           |                  |           |    |
|--|-------|--------------------|-----------|----|--|-----------|------------------|-----------|----|
|  | 36 mm | Steel              | VP02A0003 | 1  |  | 36 mm     | Stainless steel  | VP02A0004 | 1  |
|  |       |                    | VP03A0003 | 1  |  |           |                  | VP03A0004 | 1  |
|  | 27 mm | Effective length   | VP02B0003 | 24 |  | VP02B0004 | 24               |           |    |
|  |       |                    | VP03C0003 | 18 |  | VP03C0004 | 18               |           |    |
|  | 41 mm | Steel              | VP02A0005 | 1  |  | 41 mm     | Stainless steel  | VP02A0006 | 1  |
|  |       |                    | VP03A0005 | 1  |  |           |                  | VP03A0006 | 1  |
|  | 32 mm | Effective length   | VP02B0005 | 24 |  | VP02B0006 | 24               |           |    |
|  |       |                    | VP03C0005 | 18 |  | VP03C0006 | 18               |           |    |
|  | 51 mm | Steel              | VP02A0007 | 1  |  | 51 mm     | Stainless steel  | VP02A0008 | 1  |
|  |       |                    | VP03A0007 | 1  |  |           |                  | VP03A0008 | 1  |
|  | 42 mm | Effective length   | VP02B0007 | 24 |  | VP02B0008 | 24               |           |    |
|  |       |                    | VP03C0007 | 18 |  | VP03C0008 | 18               |           |    |
|  | 55 mm | Steel              | VP02A0010 | 1  |  | 55 mm     | Stainless steel  | VP02A0011 | 1  |
|  |       |                    | VP03A0010 | 1  |  |           |                  | VP03A0011 | 1  |
|  | 46 mm | Effective length   | VP02B0010 | 24 |  | VP02B0011 | 24               |           |    |
|  |       |                    | VP03C0010 | 18 |  | VP03C0011 | 18               |           |    |
|  | 51 mm | For steel profiles | VP02A0009 | 1  |  | 51 mm     | Effective length | VP02B0009 | 24 |
|  |       |                    | VP03A0009 | 1  |  |           |                  | VP03C0009 | 18 |
|  | 42 mm | Effective length   | VP02B0009 | 24 |  |           |                  |           |    |
|  |       |                    | VP03C0009 | 18 |  |           |                  |           |    |

## Adjustable spacing collars

Only with mounting plate

| Variation             | Item number     | PU**      |    |
|-----------------------|-----------------|-----------|----|
| 13.5 – 17.5 mm yellow | Steel           | A650A0020 | 24 |
|                       | Stainless steel | A650A0021 | 24 |
| 17.5 – 25 mm red      | Steel           | A650A0022 | 24 |
|                       | Stainless steel | A650A0023 | 24 |
| 25 – 32.5 mm green    | Steel           | A650A0024 | 24 |
|                       | Stainless steel | A650A0025 | 24 |
| 32.5 – 40 mm blue     | Steel           | A650A0026 | 24 |
|                       | Stainless steel | A650A0027 | 24 |
| 40 – 47.5 mm black    | Steel           | A650A0028 | 24 |
|                       | Stainless steel | A650A0029 | 24 |

## Mounting plate

|  |       |           |    |
|--|-------|-----------|----|
|  | 15 mm | VP02A0000 | 1  |
|  |       | VP03A0000 | 1  |
|  |       | VP02B0000 | 24 |
|  |       | VP03C0000 | 18 |
|  | 21 mm | VP02A0001 | 1  |
|  |       | VP03A0001 | 1  |
|  |       | VP02B0001 | 24 |
|  |       | VP03C0001 | 18 |

\* PU for = Packing unit for indicated number of hinges

\*\* PU = Packing unit



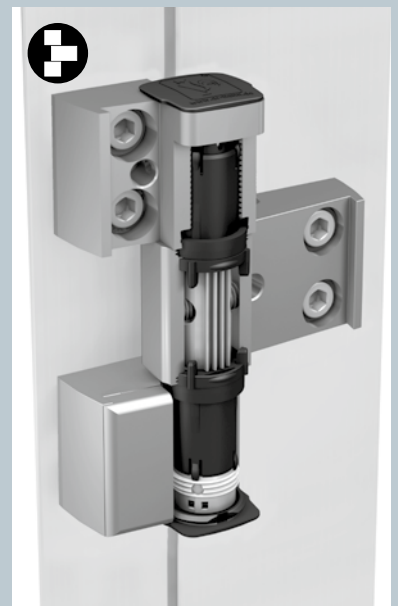
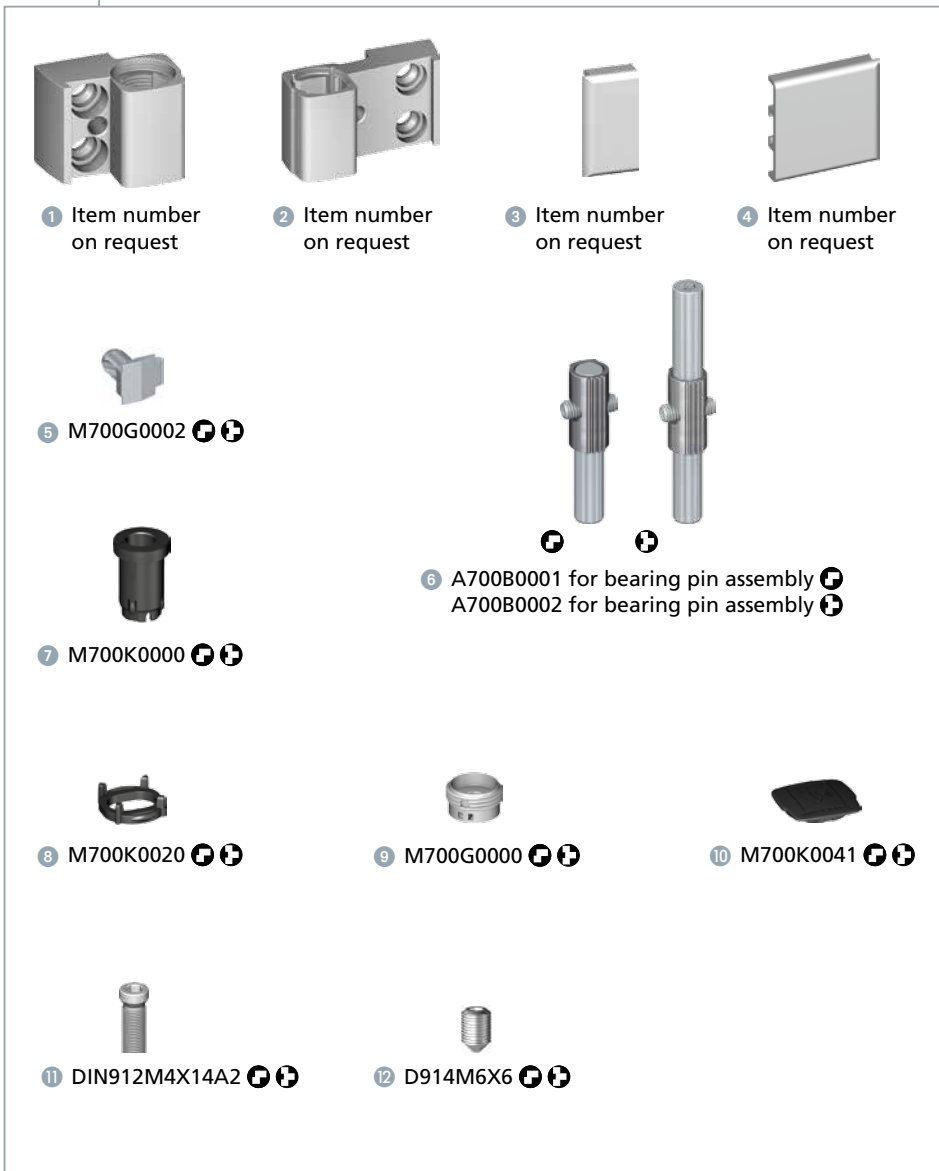
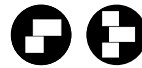

- 1 Frame hinge blade
- 2 Door hinge blade
- 3 Cover strip for frame hinge blade
- 4 Cover strip for door hinge blade
- 5 Tension bolt
- 6 Bearing pin
- 7 Bearing bushing
- 8 Upthrust washer
- 9 Lifting and lowering spindle
- 10 Cap
- 11 Screw M4 x 14
- 12 Set-screw M6 x 6

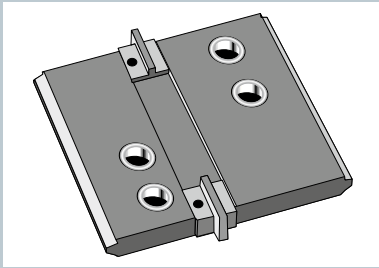
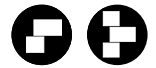

Drilling jig consisting of:

- 1 drill plate
- 3 pairs of spacers for shadow groove (4, 5 and 6 mm)
- 2 grooved pins Ø 5 mm for self-installation

Spacers

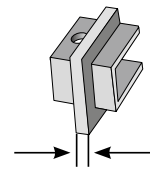

4 mm, 5 mm or 6 mm

Item numbers see page 10

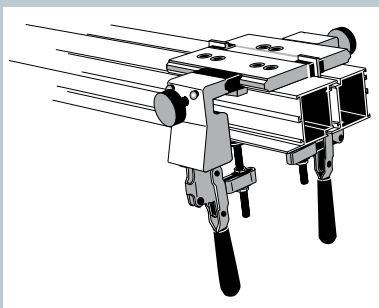

Add-on set for setting up a quick-clamping drilling jig consisting of:

- 2 clamping units
- 2 large spacers with 4 screws M6 x 75
- 1 small spacer with 2 screws M6 x 60
- 4 screws M6 x 40 (for installation without spacers)

The add-on set is mounted on the existing drilling jig.  
The quick-clamping drilling jig is suited for projected widths up to approx. 90 mm (frame) or approx. 110 mm (leaf).

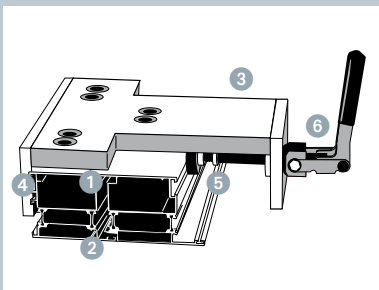

Quick-clamping drilling jig

- 1 Omission of spacers on the hinge side
- 2 No longer necessary to twist sections
- 3 Less clamping tools – no complicated fastening of drilling jig with screw clamps
- 4 Section-fitted mounting
- 5 Plastic pressure disk to prevent damage to section
- 6 Pretension adjustable to section tolerances

Please contact us if you would like to order a quick-clamping drilling jig.

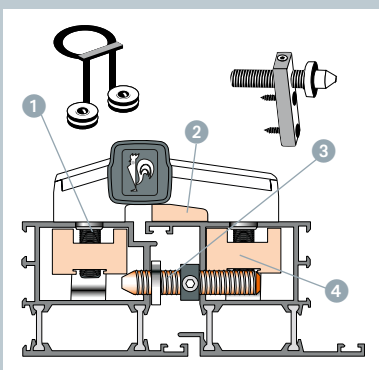

Special accessories for intrusion protection

(Special design for intrusion-resistant doors)

- 1 Set of balls for securing the hexagon sockets of fastening screws for doors that open outwards
- 2 Plate to support the hinge blade on the section
- 3 Collared safety mandrel to prevent the door from being forced open
- 4 Section-based mounting plates
- 5 Snap-off screw



For item numbers see overleaf

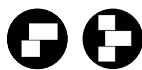

Wide mounting plates for thin-walled steel sections

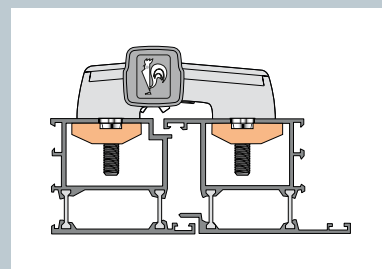

Special rust-proof version

Mounting plate







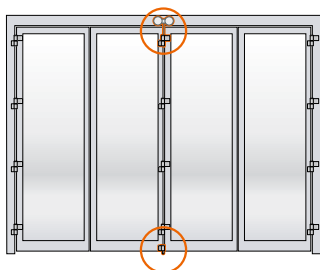

Folding door hinges

Hinge for roller unit,  
suitable for folding door hinges  
**M12 and M16**

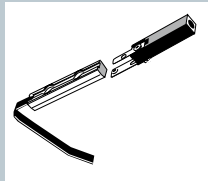

# Hahn Serie 60 AT

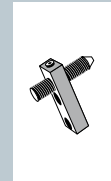
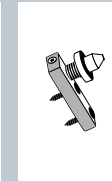
## Item numbers Accessories

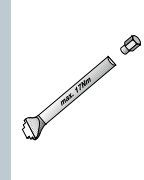
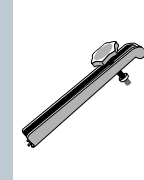
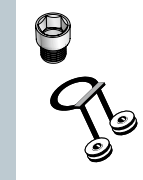
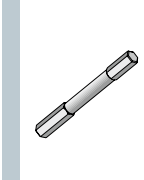
|   |   |  |   |   |   |
|---|---|--|---|---|---|
| Positioning aid   | Slip-type drill bush 5 mm/ 11 mm  | Step drill 11 mm diameter  | Ball set  | Safety mandrel  | Safety mandrel with collar  |
|  |  |  |  |  |  |
| A650A0039   | A650A0056   | A650A0035  | A850A0011   | A650A0017   | A850A0000   |
| Counterbore 11 mm/15 mm   | Special screw driver for adjustable spacing collar                                | BIT screw driver for adjustable spacing collar                                     | Drawing tool (for 3-piece hinges)   | Security kit (for 3-piece hinges)   | Special bit for screw anchors and fastening screws                                  |
|  |  |   |   |  |  |
| A650A0033   | A650A0036   | A650A0037  | A850A0015   | A650A0107   | A750A0027   |

In the standard delivery condition, Hahn Serie 60 AT is always delivered without fastening elements. Hahn hinge and Hahn fastening elements are ideally geared to each other. Please note that due to this, product warranty for the proper functionality of the products is subject to the use of both original products. Dr. Hahn does not assume liability if third-party products are used.

**Please note:** Hahn Serie 60 AT is offered with pivoting points up to 36 mm. If through any further processing higher pivoting points are achieved the producer's liability becomes void.